



Jebavy Drive

POB

ROW

ROW

N Jebavy Dr

ROW

ROW

HMA REMOVAL &
REPLACEMENT REQUIRED -
FIELD VERIFY

W King Dr
King Drive

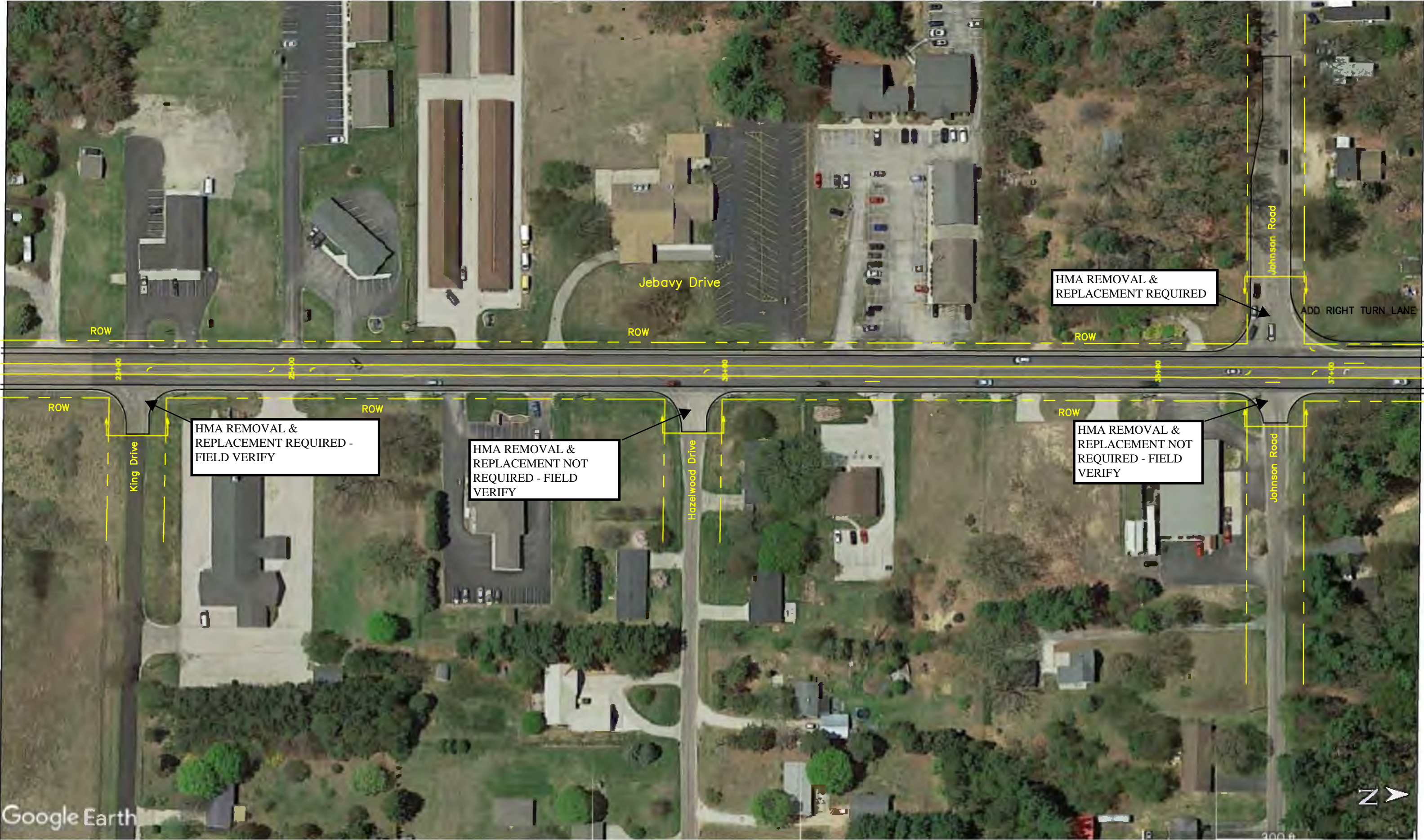

Jebavy Drive

ROW

ROW

HMA REMOVAL & REPLACEMENT REQUIRED

ADD RIGHT TURN LANE

Johnson Road

ROW

ROW

ROW

ROW

HMA REMOVAL & REPLACEMENT REQUIRED - FIELD VERIFY

HMA REMOVAL & REPLACEMENT NOT REQUIRED - FIELD VERIFY

HMA REMOVAL & REPLACEMENT NOT REQUIRED - FIELD VERIFY

King Drive

Hazelwood Drive

Johnson Road

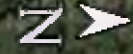



HMA REMOVAL & REPLACEMENT REQUIRED

ADD RIGHT TURN LANE

HMA REMOVAL & REPLACEMENT NOT REQUIRED - FIELD VERIFY

Jebavy Drive

Johnson Road

Johnson Road



Ludington Area Schools Elementary School Complex

Jebavy Drive

ROW

ROW

DO NOT REMOVE HMA IN THIS AREA- TRAFFIC LOOPS FOR TRAFFIC SIGNAL

Bryant Road (2021 Reconstruction & Add Center Turn Lane)

ROW

ROW

ROW

ROW

ROW

ROW

Extend Right-Turn Lane for New Elementary School Complex - not enough storage capacity

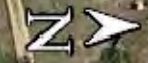



DO NOT REMOVE HMA
THIS AREA - TRAFFIC
LOOPS FOR TRAFFIC
SIGNAL

POE

Jebavy Drive

Rasmussen Road (2021 Reconstruction)



Know what's below.
Call before you dig.



Utility locations are approximate only.
Please contact "Miss Dig" three working
days prior to the start of construction
for exact locations. (1-800-482-7171)

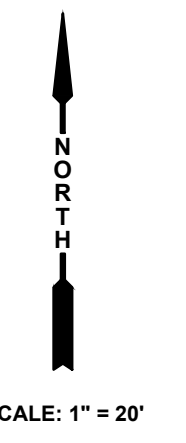

SCALE: 1" = 20'

N. JEBAVY ROAD
(A VARIABLE WIDTH PUBLIC RIGHT-OF-WAY)

010-012-300-010-00
GEORGE, MARIJEAN, JAMES, JASON USIAK
464 N JEBAVY DR

010-011-400-003-00
LUDINGTON AREA SCHOOL DISTRICT
N JEBAVY DR

010-012-300-011-00
MICHAEL & ANNETTE NEGELE
460 N JEBAVY DR

BM - 645.04
EAST-SOUTHEAST TOP FLANGE BOLT TO
HYDRANT UNDER "E" OF "EJIW".
LOCATED 32'± EAST OF C/L JEBAVY DR
& 330'± NORTH OF C/L JOHNSON RD.

**MDOT TYPE M
DRIVEWAY OPENING**

REMOVE

STM CB#1
RIM 642.39
12" CONC INV E 638.49
BOTTOM STRUCTURE 636.79
2'x2' SQ RIM
4' DIA PRECAST STRUCTURE
RIM ON S SIDE OF STRUCTURE

CB #1A - MDOT K Cover
Rim = 642.15
12" Inv. E = 638.50
BTM = 636.50

Place 18' of 12" SLCP
(Verify inverts)

010-011-400-004-00
OCCIDENTAL CHEMICAL CORPORATION
N JEBAVY DR

**RELOCATE
POWER POLE**

REMOVE

STM CB#2
RIM 643.78
12" CONC INV S 640.48
BOTTOM STRUCTURE 638.63
2'x2' SQ RIM
4' DIA PRECAST STRUCTURE
RIM ON S SIDE OF STRUCTURE
OFFSET HALF WAY

CB #2A - MDOT K Cover
Rim = 643.50
12" Inv. SE = 640.58
BTM = 638.58

Place 19' of 12" SLCP
(Verify inverts)

Remove and
replace 385' of
MDOT F6 C&G

**RELOCATE POWER
POLE & T-COM RISER**

**PROPOSED 12' WIDE
RIGHT-TURN LANE & C&G**

EXISTING C&G

010-012-300-012-00
MICHAEL EZDEBSKI
424 N JEBAVY DR

W. JOHNSON ROAD
(A 66' WIDE PUBLIC RIGHT-OF-WAY)

**CONSTRUCTION
LIMITS**

010-014-200-018-00
BRETSCHNEIDER JEBAVY PROP LLC
377 N JEBAVY DR

**CONSTRUCTION
LIMITS**

010-013-100-001-00
BILLIE COLLIER
388 N JEBAVY DR

- SANITARY SEWER (SAN)
- STORM SEWER (STM)
- WATERMAIN (WAT)
- GAS MAIN (GAS)
- UG ELECTRIC (PWR)
- UG TELECOMMUNICATIONS (TELCOM)
- AERIAL UTILITY LINE (AERIAL)
- FENCE

LEGEND

- Δ - HYDRANT (HYD)
- - WATER VALVE (WV)
- - MANHOLE (MH)
- - CATCH BASIN (CB)
- - UTILITY POLE (UP)
- - GUY ANCHOR (GA)
- - SAN CLEANOUT (CO)
- - GAS METER (GM)
- - ELECTRIC METER (EM)
- - ELECTRIC BOX (EB)
- - TRANSFORMER (TR)
- - AIR CONDITIONER (AC)
- - TELECOMMUNICATION RISER (TR)
- - YARD LIGHT (YL)
- - LIGHT POLE (LP)
- - LIGHT POLE W/CONC BASE (LPC)
- - SURVEY IRON (FOUND)
- - SURVEY IRON (SET)
- M - MEASURED DIMENSION
- D - DEEDED DIMENSION
- P - PLATTED DIMENSION
- R - RECORDED DIMENSION
- L - LENGTH
- R - RADIUS
- CB - CHORD BEARING
- C - CHORD DISTANCE
- Δ - FIRE PROT. VALVE (FPV)
- x - UG GAS MARKER (UGM)
- x - UG TELECOMMUNICATIONS MARKER (UTM)
- - UG TELECOMMUNICATIONS BOX (UTB)
- - MAILBOX (MB)

NO.	DESCRIPTION	DATE

**JEBAVY DRIVE AT JOHNSON ROAD
TOPOGRAPHICAL SURVEY**
OF PART OF
SECTIONS 11, 12, 13, 14, TOWN 18 NORTH, RANGE 18 WEST
PERE MARQUETTE TOWNSHIP, MASON COUNTY, MICHIGAN

**MASON COUNTY
ROAD COMMISSION**
510 E. STATE STREET
P.O. BOX 147
SCOTTVILLE, MI. 49454
(231) 757-2882

SURVEY CREW / DATE: CEM LAW / 4-20-22
DRAWN BY: CEM
CHECKED BY: ERN
CONTACT INFO: info@masoncountyroads.com
DESIGN DATE: MARCH 2, 2023
PROJECT: BRYANT N JEBAVY
1 OF 1

S:\ENGINEER\Documents\2023 Projects\2023 Design\Information\Jebavy\Jebavy\Jebavy Drive\Design\Jebavy.dwg - DESIGN 20 SCALE - 3/2/2023 8:35:28 AM - Charley Miszewski

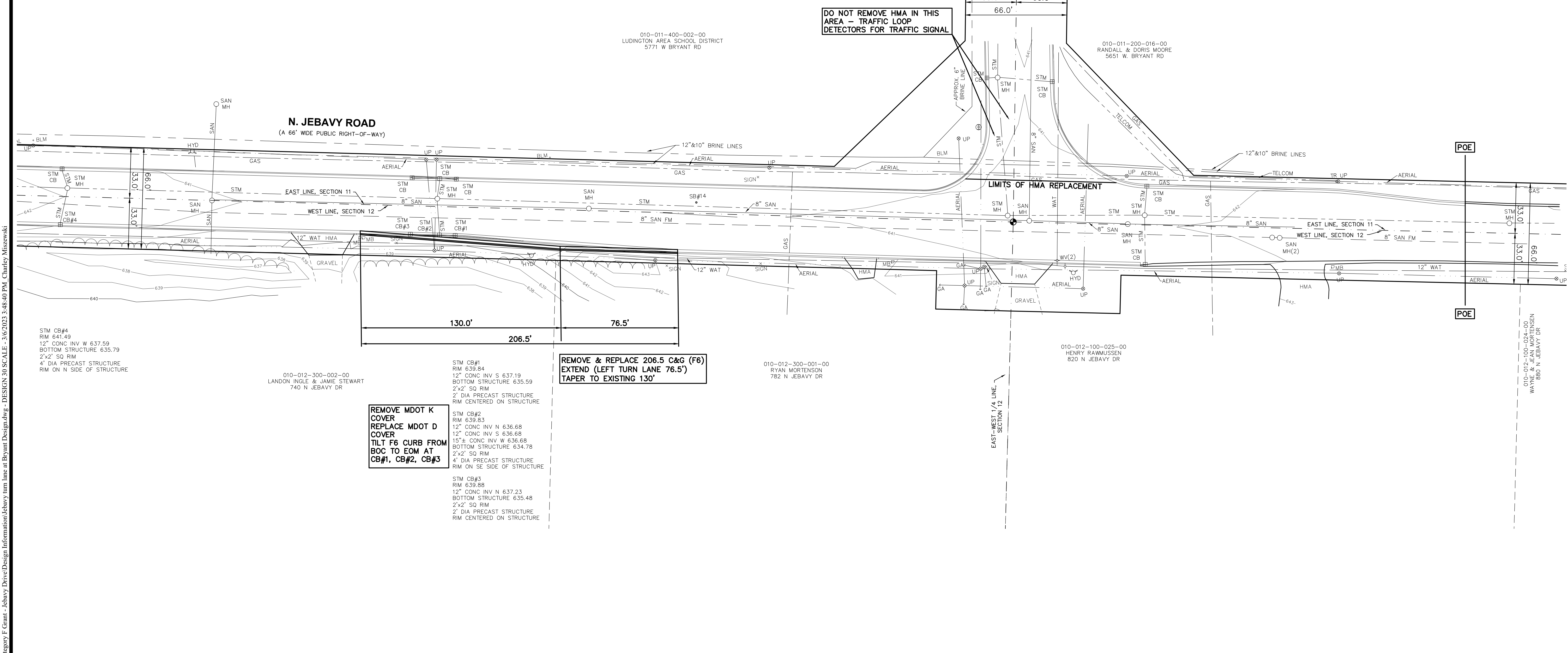

STM CB#4
RIM 641.49
12" CONC INV W 637.59
BOTTOM STRUCTURE 635.79
2'x2' SQ RIM
4' DIA PRECAST STRUCTURE
RIM ON N SIDE OF STRUCTURE

010-012-300-002-00
LONDON INGLE & JAMIE STEWART
740 N JEBAVY DR

REMOVE MDOT K
COVER
REPLACE MDOT D
COVER
TILT F6 CURB FROM
BOC TO EOM AT
CB#1, CB#2, CB#3

STM CB#1
RIM 639.84
12" CONC INV S 637.19
BOTTOM STRUCTURE 635.59
2'x2' SQ RIM
2' DIA PRECAST STRUCTURE
RIM CENTERED ON STRUCTURE

STM CB#2
RIM 639.83
12" CONC INV N 636.68
12" CONC INV S 636.68
15" ± CONC INV W 636.68
BOTTOM STRUCTURE 634.78
2'x2' SQ RIM
4' DIA PRECAST STRUCTURE
RIM ON SE SIDE OF STRUCTURE

STM CB#3
RIM 639.88
12" CONC INV N 637.23
BOTTOM STRUCTURE 635.48
2'x2' SQ RIM
2' DIA PRECAST STRUCTURE
RIM CENTERED ON STRUCTURE

REMOVE & REPLACE 206.5 C&G (F6)
EXTEND (LEFT TURN LANE 76.5')
TAPER TO EXISTING 130'

010-012-300-001-00
RYAN MORTENSON
782 N JEBAVY DR

010-012-100-025-00
HENRY RAIMUSSEN
820 N JEBAVY DR

010-012-100-024-00
WATSON RAIMUSSEN
880 N JEBAVY DR



Utility locations are approximate only. Please contact "Miss Dig" three working days prior to the start of construction for exact locations. (1-800-482-7171)

LEGEND	
— SANITARY SEWER (SAN)	— HYDRANT (HYD)
— STORM SEWER (STM)	— WATER VALVE (WV)
— WATERMAIN (WAT)	— MANHOLE (MH)
— GAS MAIN (GAS)	— CATCH BASIN (CB)
— UG ELECTRIC (PWR)	— UTILITY POLE (UP)
— UG TELECOMMUNICATIONS (TELCOM)	— GUY ANCHOR (GA)
— AERIAL UTILITY LINE (AERIAL)	— SAN CLEANOUT (CO)
— FENCE	— GAS METER (GM)
— HOT MIX ASPHALT SURFACE (HMA)	— ELECTRIC METER (EM)
	— TRANSFORMER (TR)
	— AIR CONDITIONER (AC)
	— TELECOMMUNICATION RISER (TR)
	— YARD LIGHT (YL)
	— LIGHT POLE (LP)
	— LIGHT POLE W/CONC BASE (LPC)
	— SURVEY IRON (FOUND)
	— SURVEY IRON (SET)
	— MEASURED DIMENSION
	— DEEDED DIMENSION
	— PLATTED DIMENSION
	— RECORDED DIMENSION
	— LENGTH
	— RADIUS
	— CHORD BEARING
	— CHORD DISTANCE
	— FIRE PROT. VALVE (FPV)
	— UG GAS MARKER (UGM)
	— TELECOMMUNICATION MARKER (UTM)
	— UG TELECOMMUNICATIONS BOX (UTB)
	— MAILBOX (MB)

PLAN REVISIONS	<p>JEBAVY DRIVE AT BRYANT ROAD TOPOGRAPHICAL SURVEY</p> <p>OF PART OF SECTION 11 & 12, TOWN 18 NORTH, RANGE 18 WEST PERE MARQUETTE TOWNSHIP, MASON COUNTY, MICHIGAN</p>	<p>MASON COUNTY ROAD COMMISSION 510 E. STATE STREET P.O. BOX 147 SCOTTVILLE, MI. 49454 (231) 757-2882</p>	SURVEY CREW / DATE:
			DESIGN DRAWN BY: ERN
			CHECKED BY: ERN
			CONTACT INFO: info@masoncountyorroads.com
			DESIGN DATE: MARCH 3, 2023
			PROJECT: BRYANT N JEBAVY
			1 OF 1

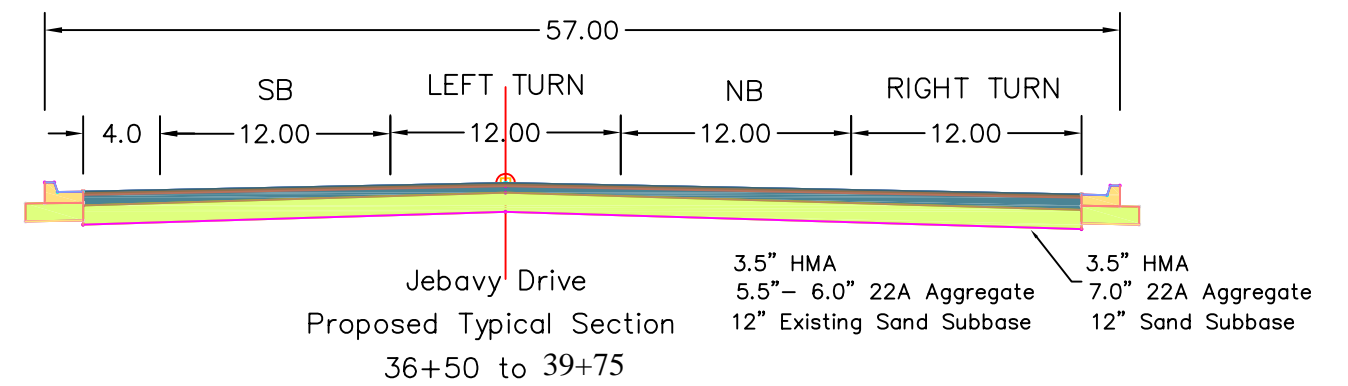
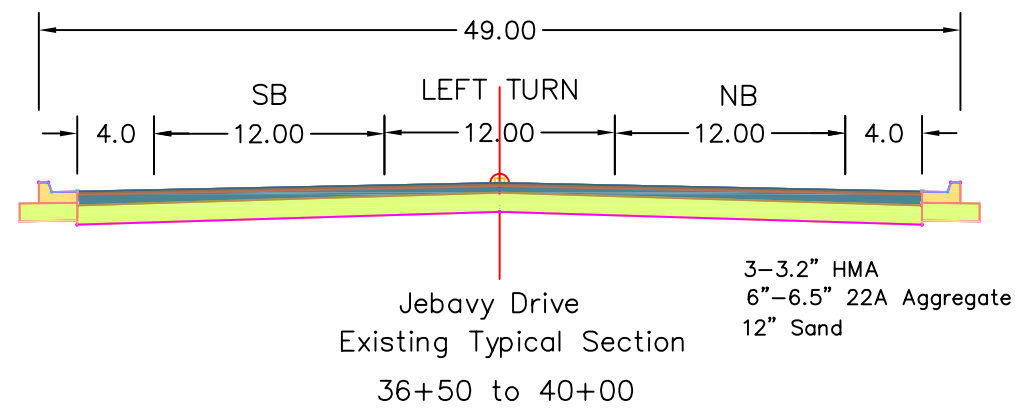
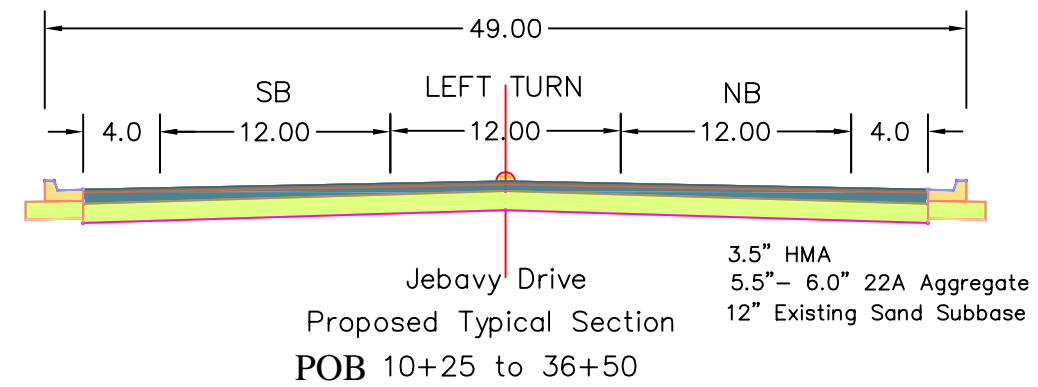
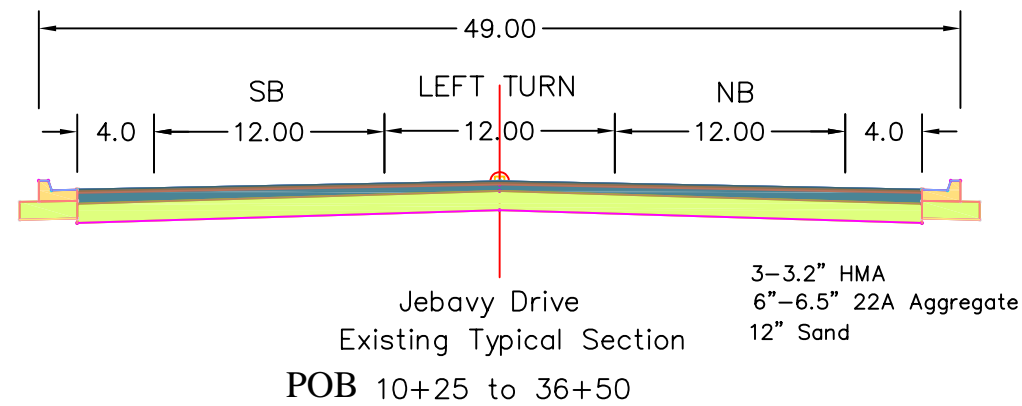

** Taper from 39+75 to 41+00

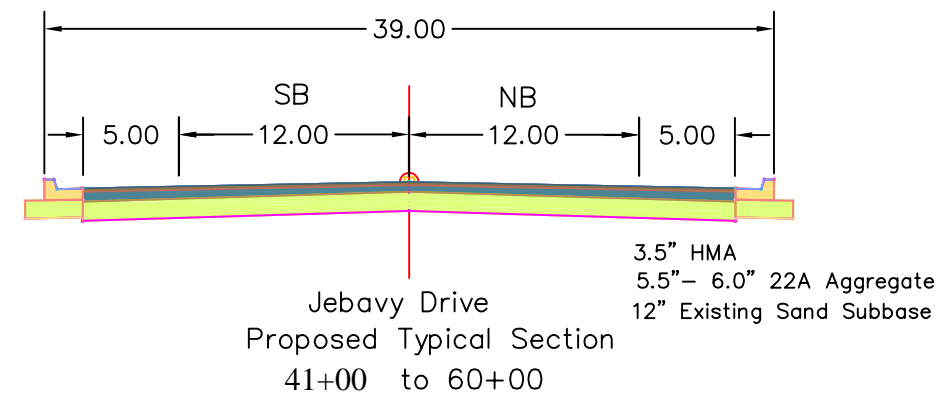
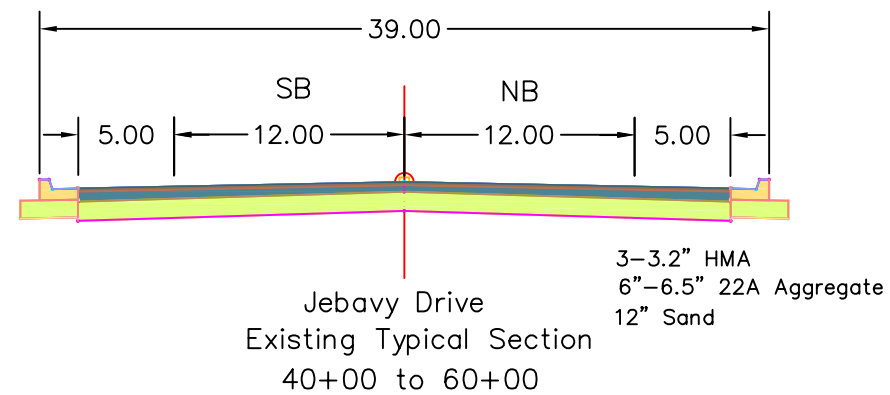

Jebavy Drive

<p>HMA, 4E1 LEVELING 220#/SYD (PG58-28) SURFACE 165#/SYD (PG64-28)</p>
--

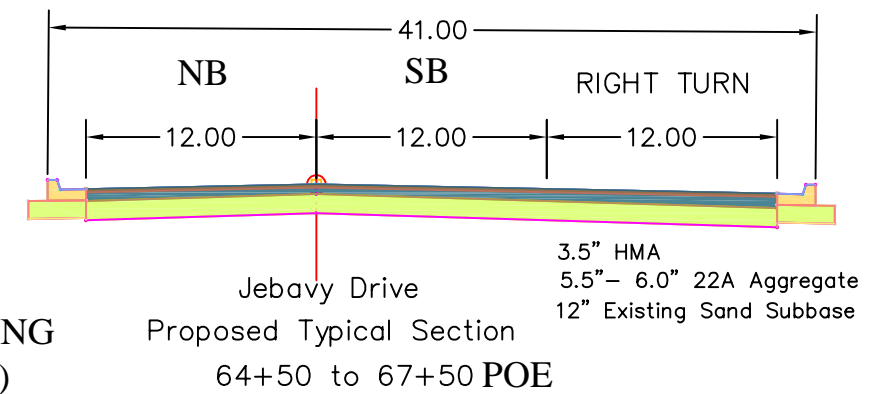
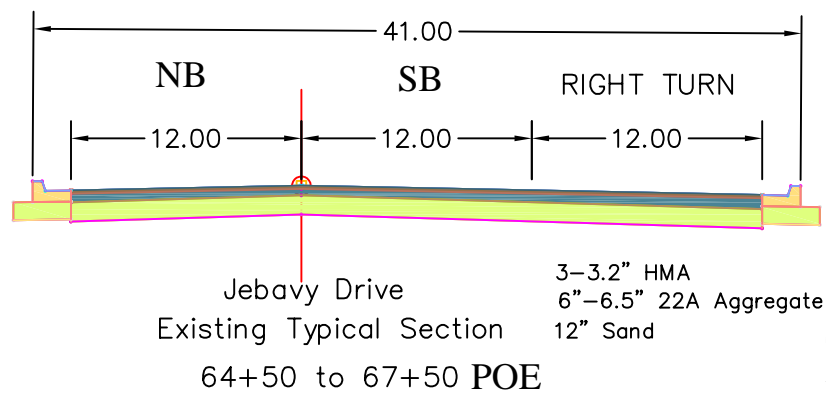
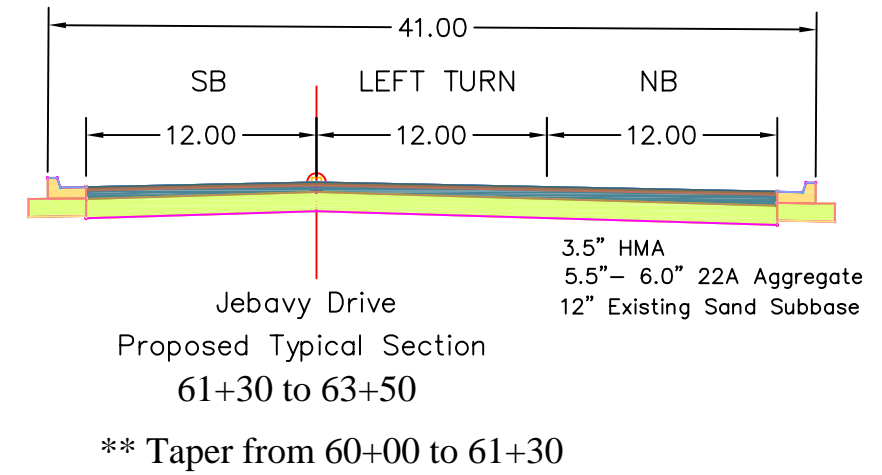
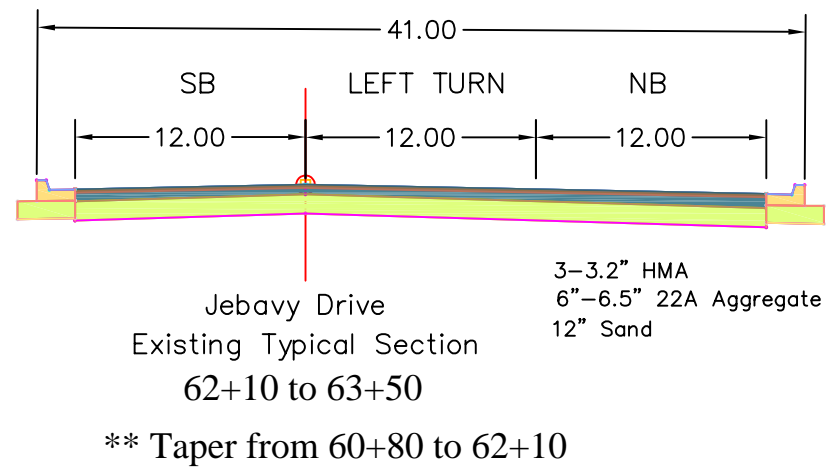

THIS TYPICAL SECTION IS LOOKING NORTH TO SOUTH (BACKWARDS)

HMA, 4E1
LEVELING 220#/SYD (PG58-28)
SURFACE 165#/SYD (PG64-28)

Jebavy Drive

Jebavy Drive - US-10 to N. of Bryant

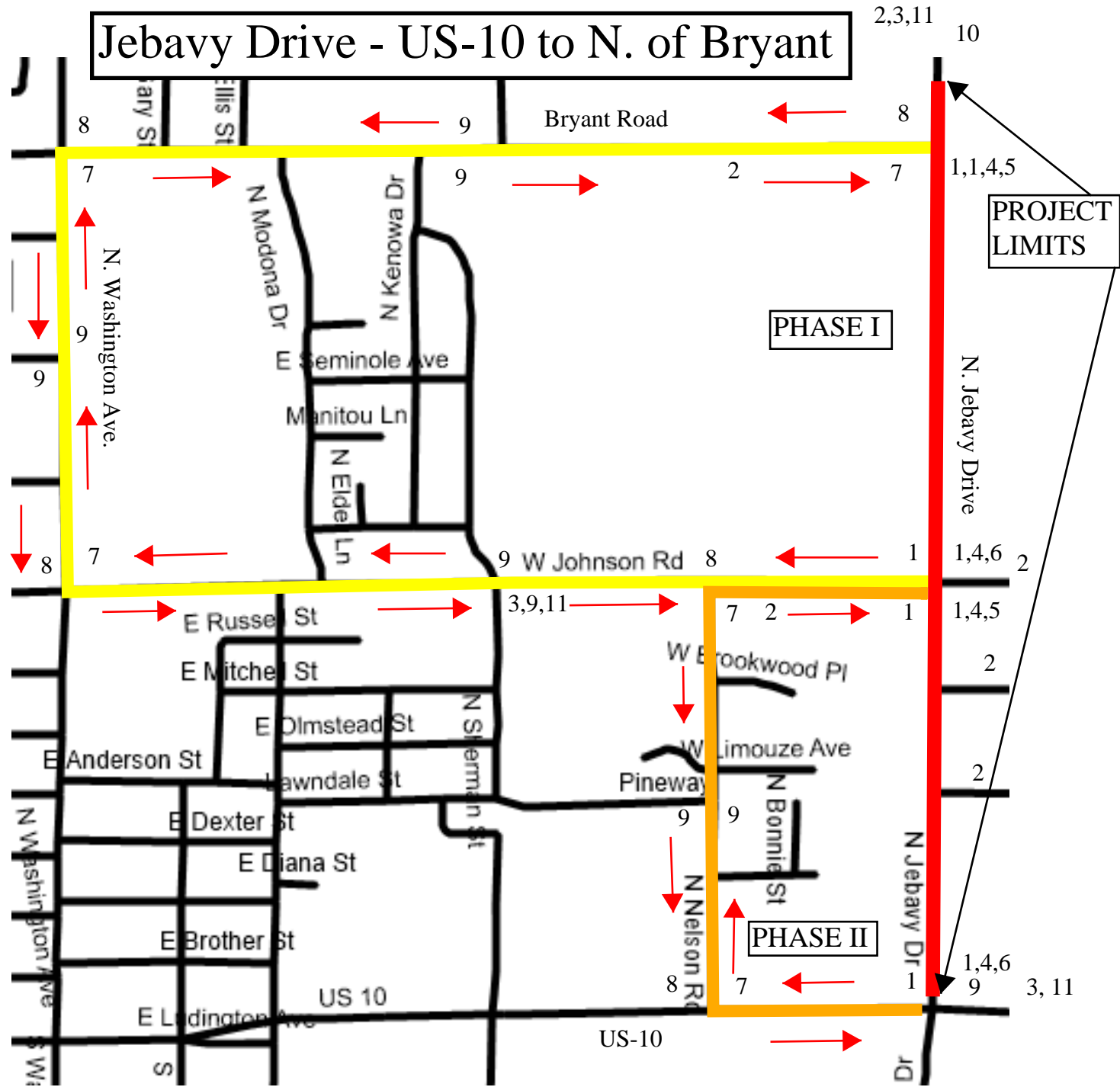

DETOUR SIGNING DETAIL

SYM	DESCRIPTION	NAME	SIGN SIZE	QTY	SFT TOTAL
1	BARRICADE TYPE II			8	
2	ROAD WORK AHEAD	W20-1	48" X 48"	6	96
3	DETOUR AHEAD	W20-2	48" X 48"	3	48
4	ROAD CLOSED TO THRU TRAFFIC	R11-4	60" X 30"	4	50
5	DETOUR →	M4-10R	48" X 18"	2	12
6	DETOUR ←	M4-10L	48" X 18"	2	12
7	DETOUR →	M4-9R	30" X 24"	5	25
8	DETOUR ←	M4-9L	30" X 24"	5	25
9	DETOUR ↑	M4-9S	30" X 24"	7	35
10	END DETOUR	M48a	24" X 18"	1	3
11	JEBAVY DRIVE	D3-1	24" X 12"	3	6
					312