

ADDENDUM #2

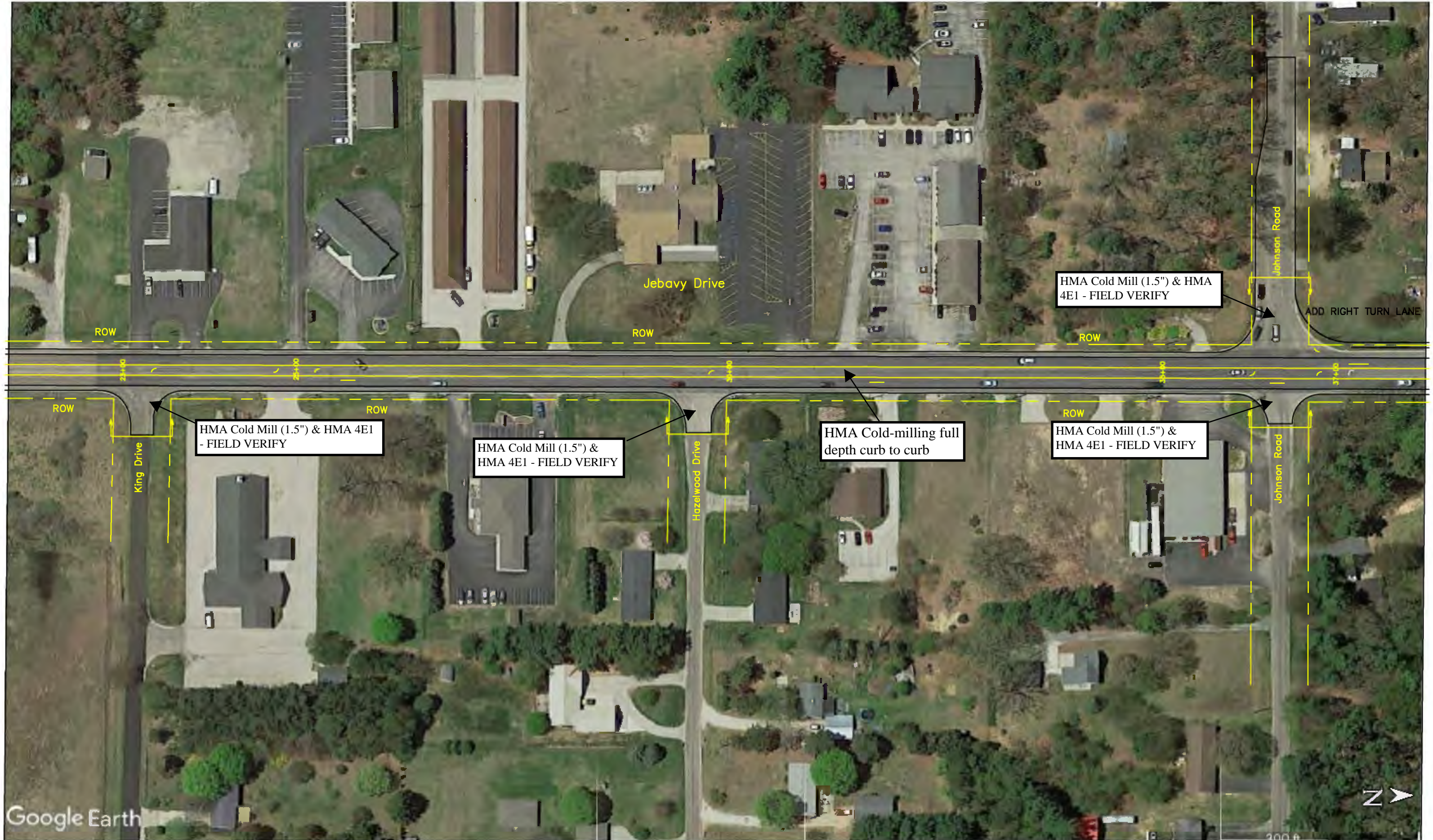







Ludington Area Schools Elementary School Complex

HMA Cold-milling full depth curb to curb

Jebavy Drive

DO NOT REMOVE HMA IN THIS AREA- TRAFFIC LOOPS FOR TRAFFIC SIGNAL

Bryson Road (2021 Reconstruction & Add Center Turn Lane)

Extend Right-Turn Lane for New Elementary School Complex - not enough storage capacity

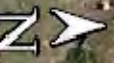



DO NOT REMOVE HMA
THIS AREA - TRAFFIC
LOOPS FOR TRAFFIC
SIGNAL

POE

Jebavy Drive

HMA Cold-milling
full depth curb to curb



Know what's below.
Call before you dig.



Utility locations are approximate only.
Please contact "Miss Dig" three working
days prior to the start of construction
for exact locations. (1-800-482-7171)

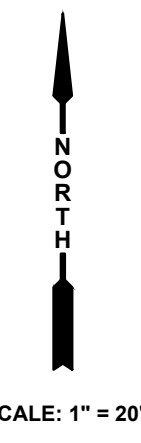

SCALE: 1" = 20'

N. JEBAVY ROAD
(A VARIABLE WIDTH PUBLIC RIGHT-OF-WAY)

010-012-300-010-00
GEORGE, MARIJEAN, JAMES, JASON USIAK
464 N JEBAVY DR

010-011-400-003-00
LUDINGTON AREA SCHOOL DISTRICT
N JEBAVY DR

010-012-300-011-00
MICHAEL & ANNETTE NEGELE
460 N JEBAVY DR

BM - 645.04
EAST-SOUTHEAST TOP FLANGE BOLT TO
HYDRANT UNDER "E" OF "EJIW".
LOCATED 32'± EAST OF C/L JEBAVY DR
& 330'± NORTH OF C/L JOHNSON RD.

MDOT TYPE M
DRIVEWAY OPENING

REMOVE

STM CB#1
RIM 642.39
12" CONC INV E 638.49
BOTTOM STRUCTURE 636.79
2'x2' SQ RIM
4' DIA PRECAST STRUCTURE
RIM ON S SIDE OF STRUCTURE

CB #1A - MDOT K Cover
Rim = 642.15
12" Inv. E = 638.50
BTM = 636.50

Place 18' of 12" SLCPP
(Verify inverts)

010-011-400-004-00
OCCIDENTAL CHEMICAL CORPORATION
N JEBAVY DR

**RELOCATE
POWER POLE**

REMOVE

STM CB#2
RIM 643.78
12" CONC INV S 640.48
BOTTOM STRUCTURE 638.63
2'x2' SQ RIM
4' DIA PRECAST STRUCTURE
RIM ON S SIDE OF STRUCTURE
OFFSET HALF WAY

CB #2A - MDOT K Cover
Rim = 643.50
12" Inv. SE = 640.58
BTM = 638.58

Place 19' of 12" SLCPP
(Verify inverts)

Remove and
replace 385' of
MDOT F6 C&G

**RELOCATE POWER
POLE & T-COM RISER**

**PROPOSED 12' WIDE
RIGHT-TURN LANE & C&G**

010-012-300-012-00
MICHAEL EZDEBSKI
424 N JEBAVY DR

EXISTING C&G

**CAUTION
GAS MAIN**

W. JOHNSON ROAD
(A 66' WIDE PUBLIC RIGHT-OF-WAY)

CONSTRUCTION
LIMITS

CONSTRUCTION
LIMITS

010-014-200-018-00
BRETSCHNEIDER JEBAVY PROP LLC
377 N JEBAVY DR

010-013-100-001-00
BILLIE COLLIER
388 N JEBAVY DR

- SANITARY SEWER (SAN)
- STORM SEWER (STM)
- WATERMAIN (WAT)
- GAS MAIN (GAS)
- UG ELECTRIC (PWR)
- UG TELECOMMUNICATIONS (TELCOM)
- AERIAL UTILITY LINE (AERIAL)
- FENCE

LEGEND

- Δ - HYDRANT (HYD)
- - WATER VALVE (WV)
- - MANHOLE (MH)
- - CATCH BASIN (CB)
- - UTILITY POLE (UP)
- - GUY ANCHOR (GA)
- - SAN CLEANOUT (CO)
- - GAS METER (GM)
- - ELECTRIC METER (EM)
- - ELECTRIC BOX (EB)
- - TRANSFORMER (TR)
- - AIR CONDITIONER (AC)
- - TELECOMMUNICATION RISER (TR)
- - YARD LIGHT (YL)
- - LIGHT POLE (LP)
- - LIGHT POLE W/CONC BASE (LPC)
- - SURVEY IRON (FOUND)
- - SURVEY IRON (SET)
- M - MEASURED DIMENSION
- D - DEEDED DIMENSION
- P - PLATTED DIMENSION
- R - RECORDED DIMENSION
- L - LENGTH
- R - RADIUS
- CB - CHORD BEARING
- C - CHORD DISTANCE
- Δ - FIRE PROT. VALVE (FPV)
- x - UG GAS MARKER (UGM)
- x - UG TELECOMMUNICATIONS MARKER (UTM)
- - UG TELECOMMUNICATIONS BOX (UTB)
- - MAILBOX (MB)

NO.	DATE	DESCRIPTION

**JEBAVY DRIVE AT JOHNSON ROAD
TOPOGRAPHICAL SURVEY**
OF PART OF
SECTIONS 11, 12, 13, 14, TOWN 18 NORTH, RANGE 18 WEST
PERE MARQUETTE TOWNSHIP, MASON COUNTY, MICHIGAN

**MASON COUNTY
ROAD COMMISSION**
510 E. STATE STREET
P.O. BOX 147
SCOTTVILLE, MI. 49454
(231) 757-2882

SURVEY CREW / DATE: CEM LAW / 4-20-22
DRAWN BY: CEM
CHECKED BY: ERN
CONTACT INFO: info@masoncountyroads.com
DESIGN DATE: MARCH 2, 2023
PROJECT: BRYANT N JEBAVY
1 OF 1

S:\ENGINEER\Documents\2023 Projects\2023 Design\Information\Jebavy\Jebavy\Jebavy Drive\Design\Jebavy Drive.dwg - DESIGN 20 SCALE - 3/2/2023 8:35:28 AM - Charley Miszewski

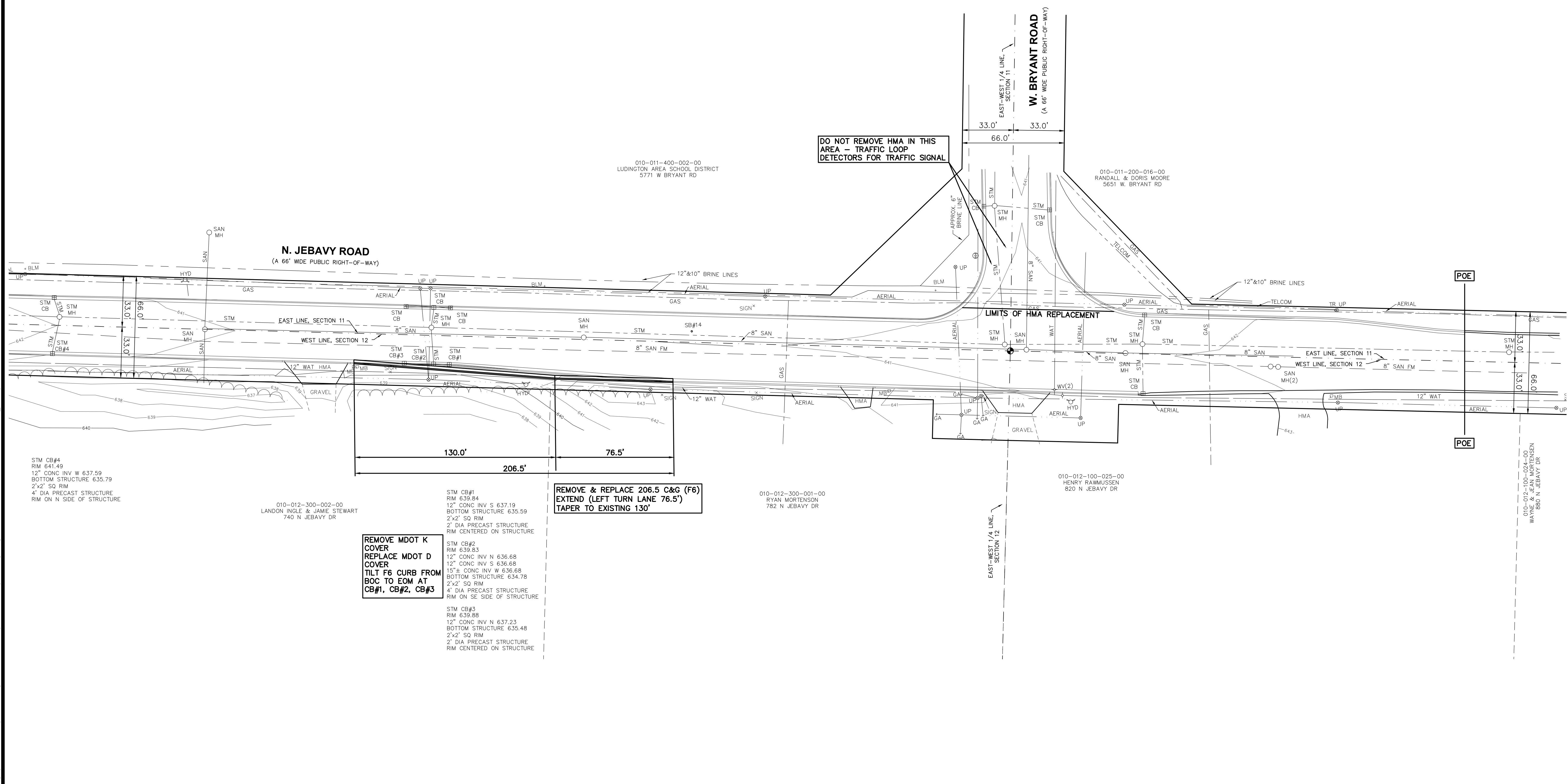

DO NOT REMOVE HMA IN THIS AREA - TRAFFIC LOOP DETECTORS FOR TRAFFIC SIGNAL

REMOVE & REPLACE 206.5 C&G (F6) EXTEND (LEFT TURN LANE 76.5') TAPER TO EXISTING 130'

REMOVE MDOT K COVER
REPLACE MDOT D COVER
TILT F6 CURB FROM BOC TO EOM AT CB#1, CB#2, CB#3

STM CB#4
RIM 641.49
12" CONC INV W 637.59
BOTTOM STRUCTURE 635.79
2'x2' SQ RIM
4" DIA PRECAST STRUCTURE
RIM ON N SIDE OF STRUCTURE

010-012-300-002-00
LONDON INGLE & JAMIE STEWART
740 N JEBAVY DR

STM CB#1
RIM 639.84
12" CONC INV S 637.19
BOTTOM STRUCTURE 635.59
2'x2' SQ RIM
2" DIA PRECAST STRUCTURE
RIM CENTERED ON STRUCTURE

STM CB#2
RIM 639.83
12" CONC INV N 636.68
12" CONC INV S 636.68
15" ± CONC INV W 636.68
BOTTOM STRUCTURE 634.78
2'x2' SQ RIM
4" DIA PRECAST STRUCTURE
RIM ON SE SIDE OF STRUCTURE

STM CB#3
RIM 639.88
12" CONC INV N 637.23
BOTTOM STRUCTURE 635.48
2'x2' SQ RIM
2" DIA PRECAST STRUCTURE
RIM CENTERED ON STRUCTURE

010-012-300-001-00
RYAN MORTENSON
782 N JEBAVY DR

010-012-100-025-00
HENRY RAIMUSSEN
820 N JEBAVY DR

010-012-100-024-00
WAYNE RAIMUSSEN
880 N JEBAVY DR

- LEGEND**
- SANITARY SEWER (SAN)
 - STORM SEWER (STM)
 - WATERMAIN (WAT)
 - GAS MAIN (GAS)
 - UG ELECTRIC (PWR)
 - UG TELECOMMUNICATIONS (TELCOM)
 - AERIAL UTILITY LINE (AERIAL)
 - FENCE
 - HOT MIX ASPHALT SURFACE (HMA)
 - ▲ - HYDRANT (HYD)
 - ◆ - WATER VALVE (WV)
 - - MANHOLE (MH)
 - ⊖ - CATCH BASIN (CB)
 - ⊕ - UTILITY POLE (UP)
 - ⊙ - GUY ANCHOR (GA)
 - - SAN CLEANOUT (CO)
 - - GAS METER (GM)
 - ⊕ - ELECTRIC METER (EM)
 - - ELECTRIC BOX (EB)
 - - TRANSFORMER (TR)
 - - AIR CONDITIONER (AC)
 - ⊕ - TELECOMMUNICATION RISER (TR)
 - ⊕ - YARD LIGHT (YL)
 - ☆ - LIGHT POLE (LP)
 - ☆ - LIGHT POLE W/CONC BASE (LPC)
 - - SURVEY IRON (FOUND)
 - - SURVEY IRON (SET)
 - M - MEASURED DIMENSION
 - D - DEEDED DIMENSION
 - P - PLATTED DIMENSION
 - R - RECORDED DIMENSION
 - L - LENGTH
 - R - RADIUS
 - CB - CHORD BEARING
 - C - CHORD DISTANCE
 - ▲ - FIRE PROT. VALVE (FPV)
 - ⊕ - UG GAS MARKER (UGM)
 - ⊕ - UG TELECOMMUNICATIONS MARKER (UTM)
 - ⊕ - UG TELECOMMUNICATIONS BOX (UTB)
 - ⊕ - MAILBOX (MB)

PLAN REVISIONS

JEBAVY DRIVE AT BRYANT ROAD
TOPOGRAPHICAL SURVEY
OF PART OF
SECTION 11 & 12, TOWN 18 NORTH, RANGE 18 WEST
PERE MARQUETTE TOWNSHIP, MASON COUNTY, MICHIGAN

MASON COUNTY
ROAD COMMISSION
510 E. STATE STREET
P.O. BOX 147
SCOTTVILLE, MI. 49454
(231) 757-2882

SURVEY CREW / DATE: CEM LAW / 4-20-22
DESIGN DRAWN BY: ERN
CHECKED BY: ERN
CONTACT INFO: info@masoncountyroads.com
DESIGN DATE: MARCH 3, 2023
PROJECT: BRYANT N JEBAVY
1 OF 1

S:\ENGINEER\Documents\2023 Projects\2023 Design\Drawings\Jebavy Drive\Design Information\Jebavy Turn Lane at Bryant Design.dwg - DESIGN 30 SCALE - 3/16/2023 3:48:40 PM - Charley Miszewski



Utility locations are approximate only. Please contact "Miss Dig" three working days prior to the start of construction for exact locations. (1-800-482-7171)

ADDENDUM #2

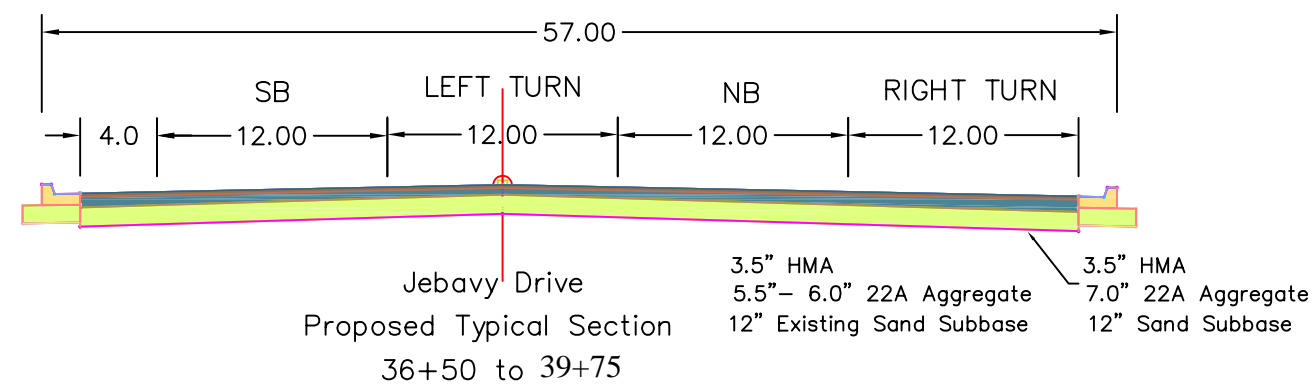
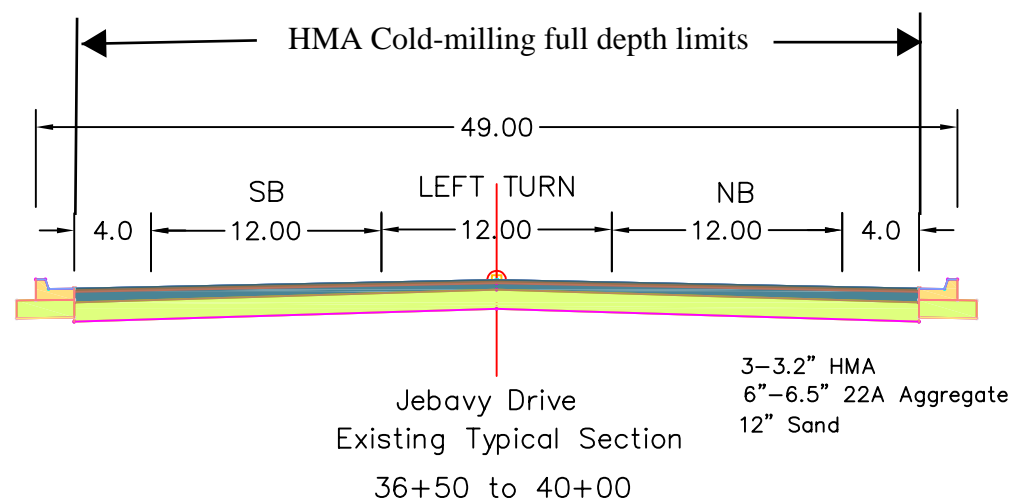
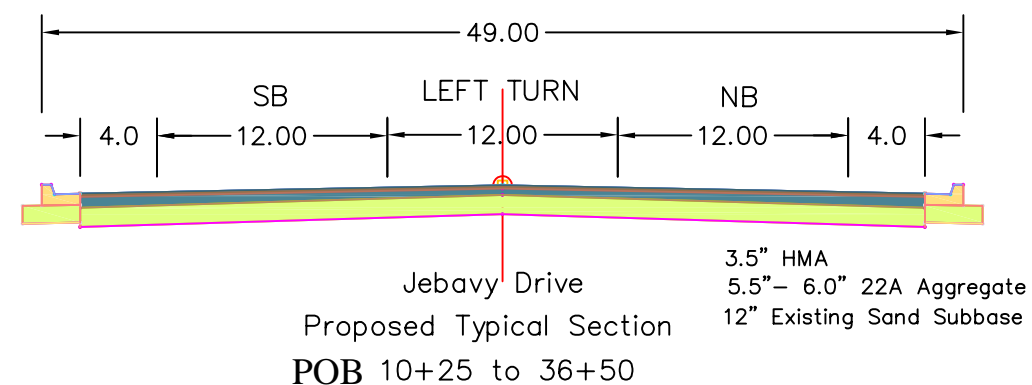
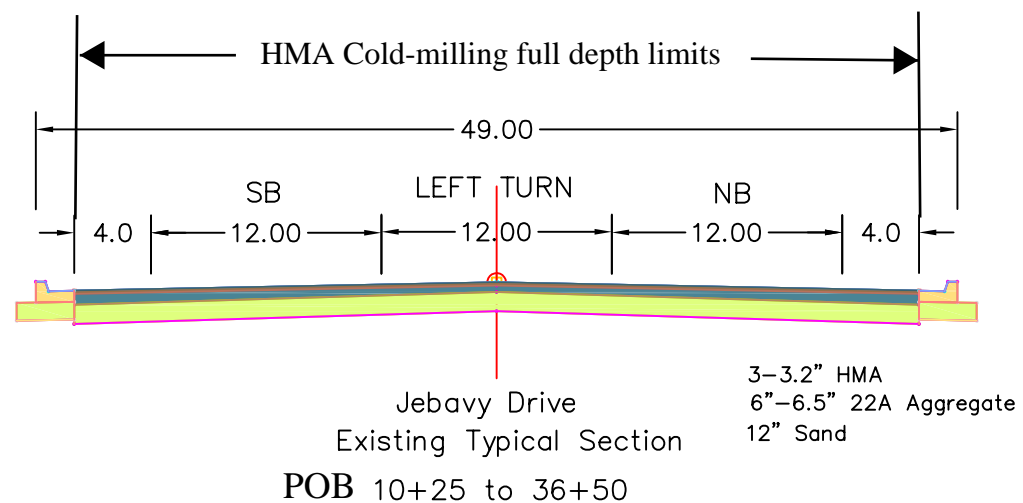

** Taper from 39+75 to 41+00

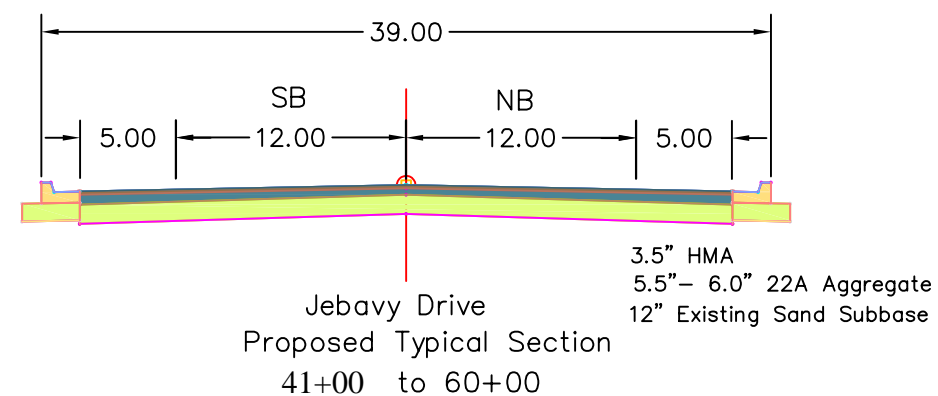
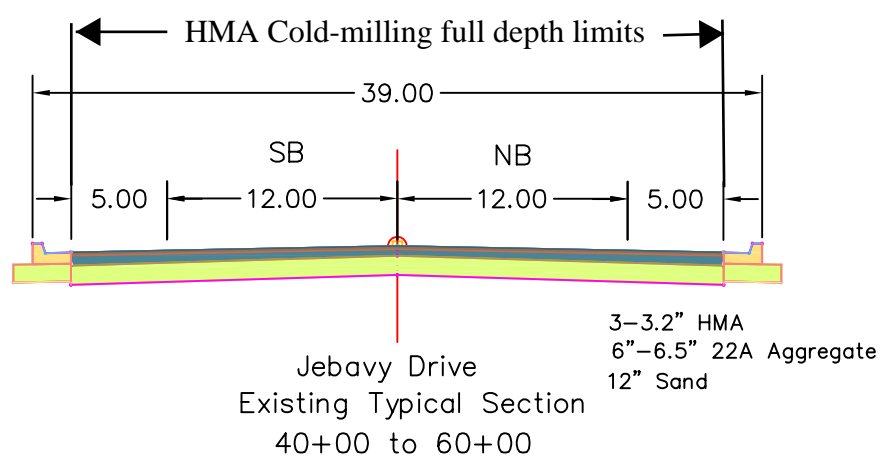

Jebavy Drive

HMA, 4E1
LEVELING 220#/SYD (PG58-28)
SURFACE 165#/SYD (PG64-28)

ADDENDUM #2

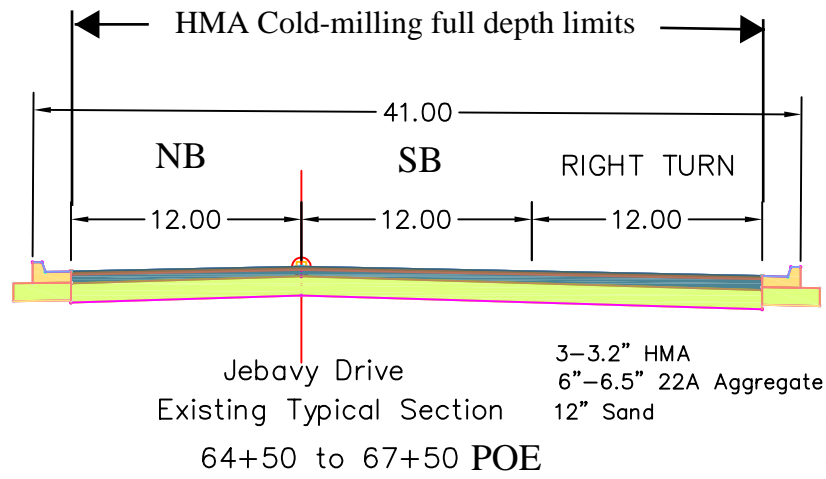
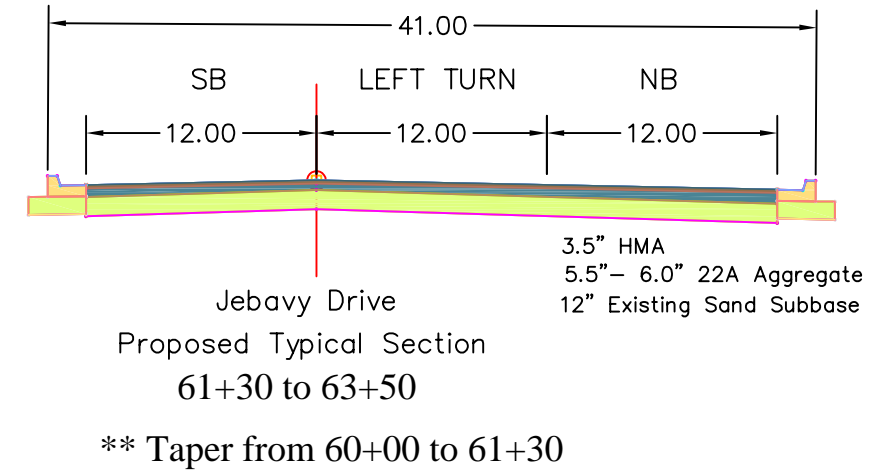
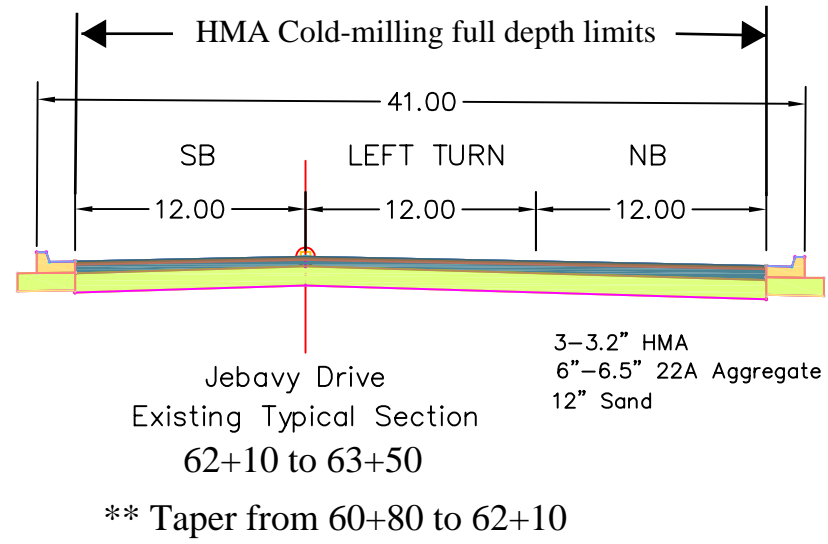

THIS TYPICAL SECTION IS LOOKING NORTH TO SOUTH (BACKWARDS)

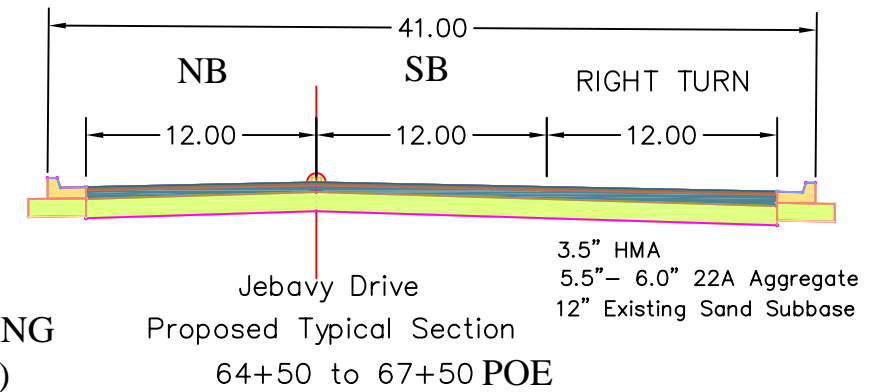

HMA, 4E1
LEVELING 220#/SYD (PG58-28)
SURFACE 165#/SYD (PG64-28)

Jebavy Drive

Jebavy Drive - US-10 to N. of Bryant

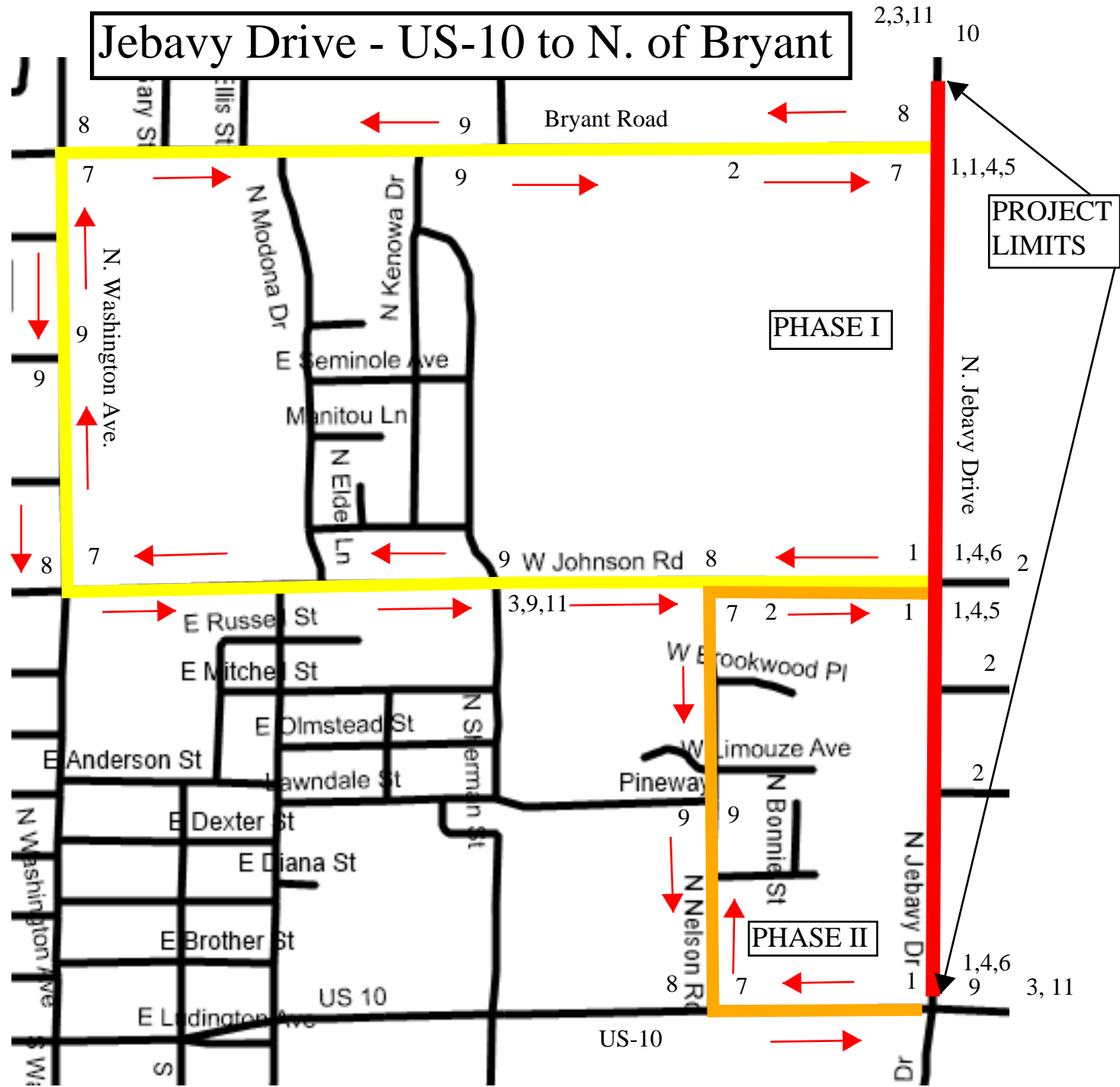

DETOUR SIGNING DETAIL

SYM	DESCRIPTION	NAME	SIGN SIZE	QTY	SFT TOTAL
1	BARRICADE TYPE II			8	
2	ROAD WORK AHEAD	W20-1	48" X 48"	6	96
3	DETOUR AHEAD	W20-2	48" X 48"	3	48
4	ROAD CLOSED TO THRU TRAFFIC	R11-4	60" X 30"	4	50
5	DETOUR →	M4-10R	48" X 18"	2	12
6	DETOUR ←	M4-10L	48" X 18"	2	12
7	DETOUR →	M4-9R	30" X 24"	5	25
8	DETOUR ←	M4-9L	30" X 24"	5	25
9	DETOUR ↑	M4-9S	30" X 24"	7	35
10	END DETOUR	M48a	24" X 18"	1	3
11	JEBAVY DRIVE	D3-1	24" X 12"	3	6
					312